

LONG-TERM BIKE PARKING



DERO
A PLAYCORE Company

LEAGUE OF AMERICAN BICYCLISTS

BIKELEAGUE.ORG



SINCE 1880...



Our mission is

**to lead the movement to
create a Bicycle Friendly
America for everyone.**

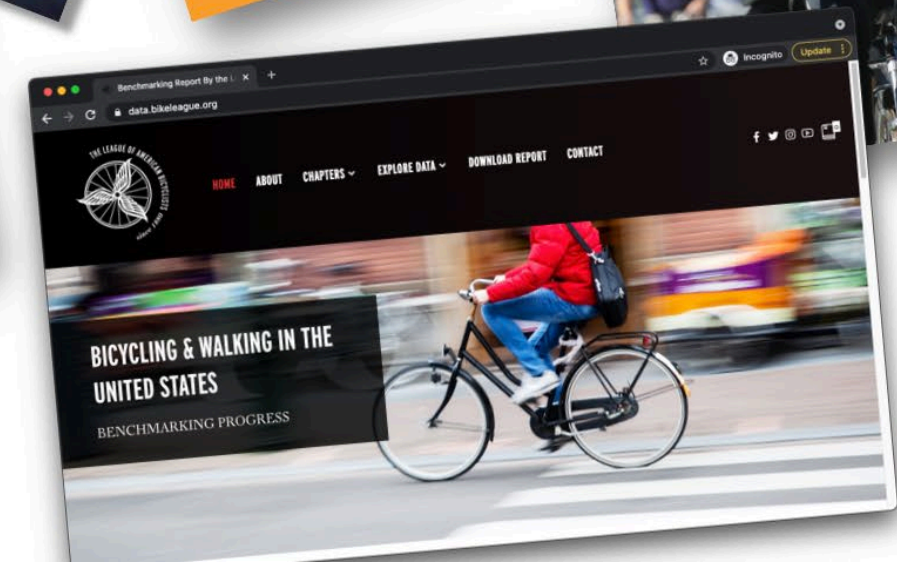

ACTIVE
TRANSPORTATION
LEADERSHIP
INSTITUTE





THE LEAGUE » BICYCLE FRIENDLY AMERICA



**BICYCLE FRIENDLY
STATE**



**BICYCLE FRIENDLY
COMMUNITY**



**BICYCLE FRIENDLY
BUSINESS**



**BICYCLE FRIENDLY
UNIVERSITY**

APPLY FOR RECOGNITION & FEEDBACK



Forbes / Lifestyle

AUG 31, 2015 @ 09:11 PM 364 VIEWS

More Businesses Across US Designated Bike-Friendly



Tanya Mohn, CONTRIBUTOR
I write about travel and road safety.

FOLLOW ON FORBES (70) f t r e
Opinions expressed by Forbes Contributors are their own.

FULL BIO

The League of American Bicyclists announced its latest round of bicycle friendly businesses last week, recognizing 100 new and renewing companies in 31 states and the District of Columbia.

NAIPTA Named a Silver Bicycle Friendly Business
SOURCE: NORTHERN ARIZONA INTERGOVERNMENTAL PUBLIC TRANSPORTATION AUTHORITY DEC 18, 2015



NAIPTA encourages bicycling as an easy option for transportation and provides amenities such as bike racks at connection centers, at bus stops, and on every single bus, and incentives such as allowing bikes to ride for free.

Photo credit: NAIPTA

RI Public Radio Named A Bicycle-Friendly Business By The League Of American Bicyclists

By JAMES BAUMGARTNER • AUG 26, 2015

SHARE Twitter Facebook Google+ Email



BICYCLE FRIENDLY BUSINESS

MINITAB INC

Feedback Report



Spring 2016 **HONORABLE MENTION**

While MINITAB INC was not selected as a Bicycle Friendly Business this round, the League of American Bicyclists is pleased to see your commitment to promote a bicycle-friendly environment for employees, guests, and the community. We are optimistic of your progress and look forward to working with you to reach a Bicycle Friendly Business award in the future.

BUSINESS PROFILE

CITY, STATE	INDUSTRY	# OF EMPLOYEES	AVERAGE DAILY # OF GUESTS
State College, PA	Technology & Information	300	5

QUICK FACTS

RIDERSHIP % of employees who ride to work more than twice per week in the spring, summer, & fall months	9%
BIKE TO WORK DAY PARTICIPATION average % of employees who commute by bike on Bike to Work Day during past three years	0
BIKE PARKING CAPACITY % of bicycle parking spaces compared to total number of employees & average daily guests	10%

CATEGORY SCORES

	Judge Rating	Local Cyclists Rating*
ENGINEERING Access and end-of-trip facilities for commuters	4.0 / 10	7.9 / 10
ENCOURAGEMENT Promotion, incentives, and advocacy for better bicycling	0.9 / 10	4.6 / 10
EDUCATION Safety, skills, and maintenance classes and information sharing	0 / 10	2.4 / 10
EVALUATION & PLANNING Setting targets, seeking input, and planning for improvements	4.8 / 10	3.1 / 10
AVERAGE SCORE out of 10	2.4	4.5

*Based on surveys distributed to employees, customers, and guests.

BUILDING BLOCKS OF A BICYCLE FRIENDLY BUSINESS

While no two BFBs are exactly alike, below we've listed the key actions taken by most successful businesses in the program.

A Bicycle Friendly Business:

- » Is easily accessible by bike
- » Is a champion for bicycling in their community
- » Offers convenient, secure bike parking
- » Supports local, state, and national bike advocacy
- » Offers classes on bicycle safety and maintenance
- » Shares bicycling information and resources with

Growth in U.S. Bicycle Commuting

Percentage of residents commuting by bike, 1990-2014

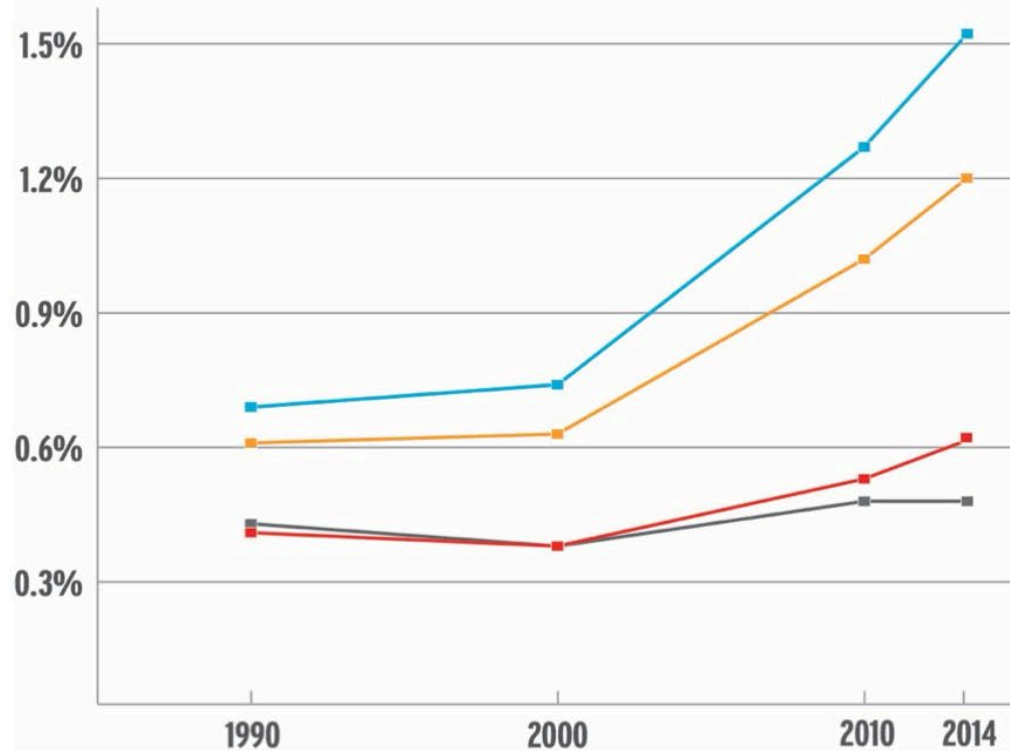

BICYCLE FRIENDLY COMMUNITIES (BFC)

70 LARGEST U.S. CITIES

U.S. AVERAGE NON-BFCs

Data: American Community Survey | BFC & non-BFC averages based on subset of 70 largest cities

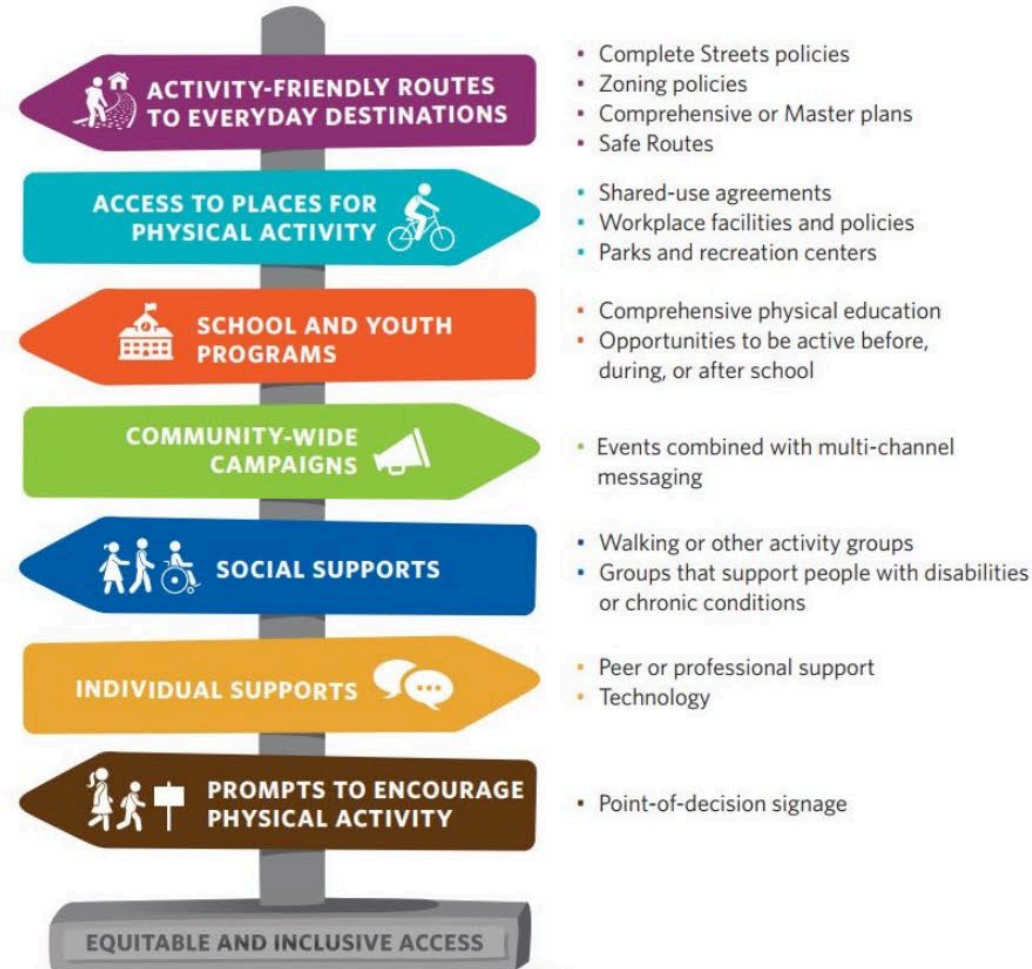

BFA APPLICATION CRITERIA



The Five E's:

- » Engineering
- » Encouragement
- » Education
- » Evaluation & Planning
- » Equity, Diversity, & Inclusion

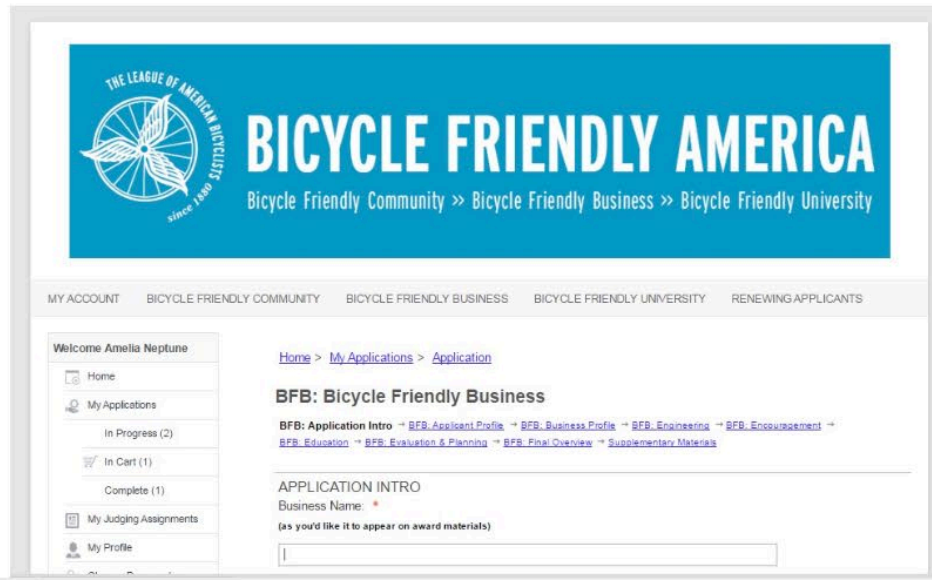

SECURE BIKE PARKING



APBP Bike Parking Guidelines:

<https://www.apbp.org/bicycle-parking-solutions>



Equality



Equity



END-OF-TRIP FACILITIES

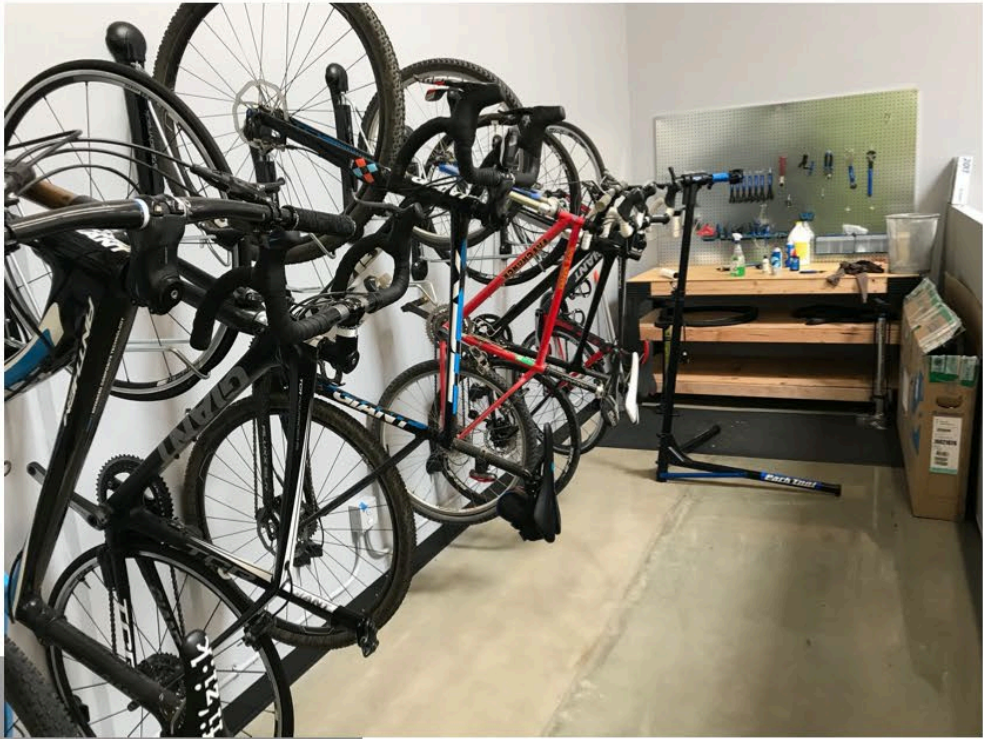

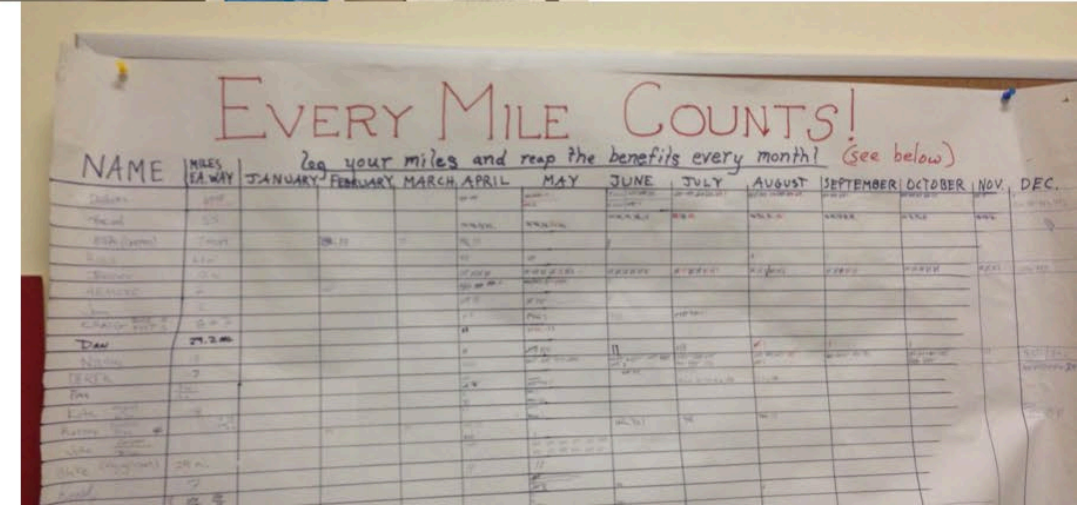

ACCESSIBILITY

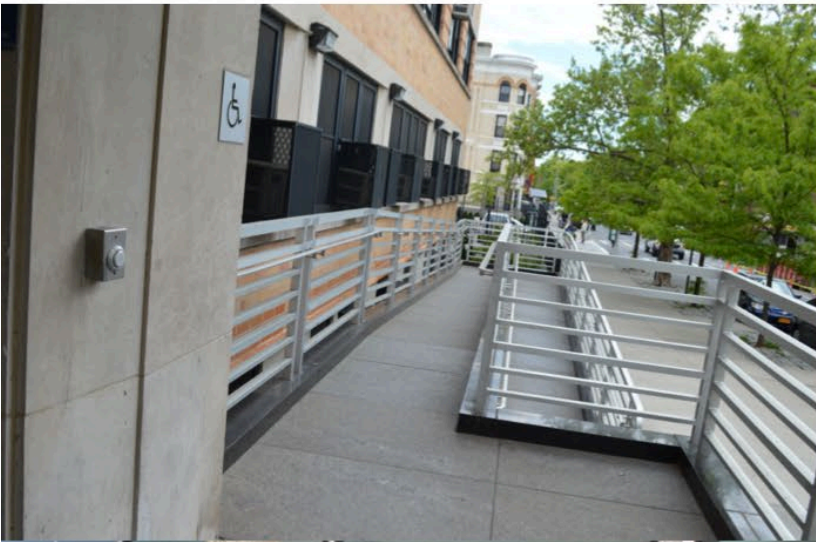

LEARN MORE...

» About the League and other programs:

» **bikeleague.org**

» About the BFC Program:

» **bikeleague.org/community**

» About the BFB Program:

» **bikeleague.org/business**

» About the BFU Program:

» **bikeleague.org/university**

» **Apply today:**

» **apply.bikeleague.org**

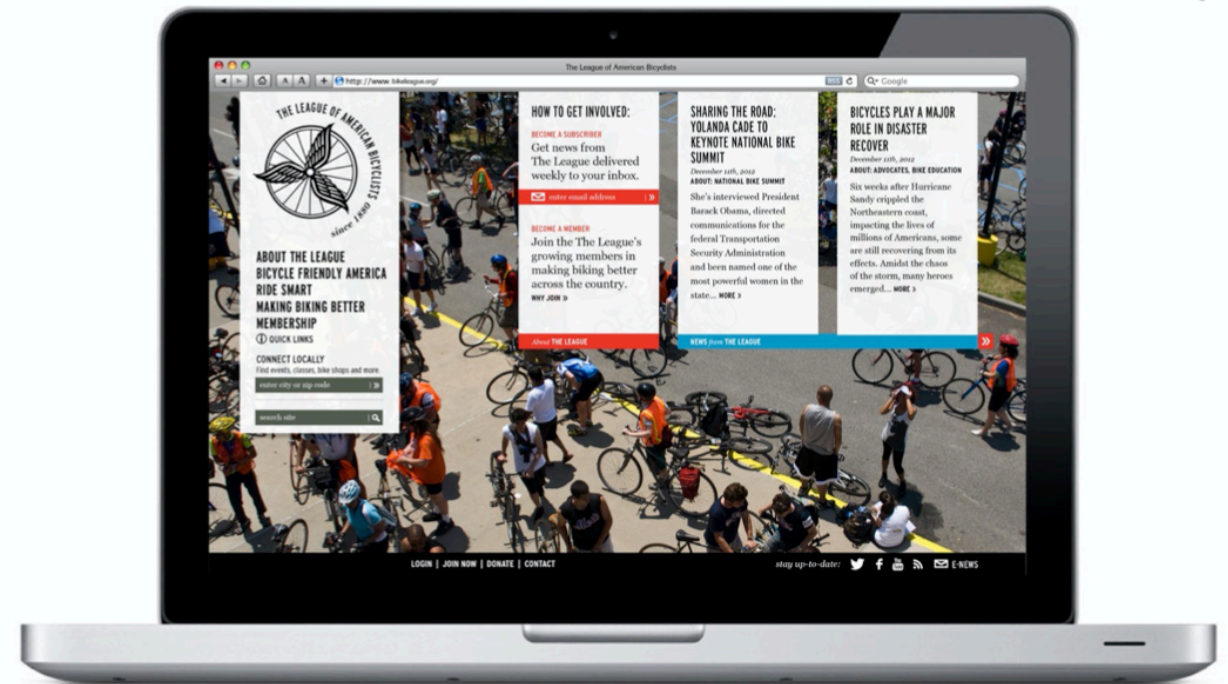

Upcoming Application Deadlines:

»BFU: October 1

»BFB: October 5

Overview

- What makes a good bike rack?
- Key elements of excellent long-term bike parking facilities
- Common pitfalls
- Proper layouts for bike rooms

Short-Term

(Less than two hours)

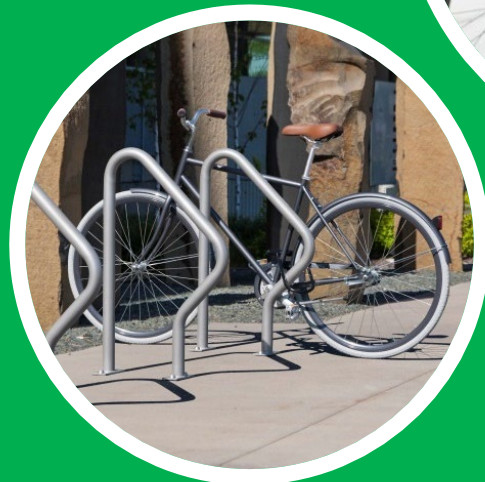

Long-Term

(More than two hours)



What makes a **good bike rack**?



- Stability of the rack
- Two points of contact with the bicycle
- Security and Ease of Use

Amenity



Afterthought



Site Considerations

- Street level
- Near building entrance and elevators
- Safe
- Convenient
- Welcoming





Bike Rack Types



HORIZONTAL

“Traditional-use” bike parking that is easily-accessible with a bike’s two wheels on the ground. These racks are highly versatile.



VERTICAL

“Max capacity” bike parking saves space on the ground by pivoting the bike onto its rear wheel and lifting to the hook.



TWO-TIER

“Premium” bike parking that offers the space-efficiency of vertical racks and the broader accessibility of horizontal racks.

Horizontal Parking

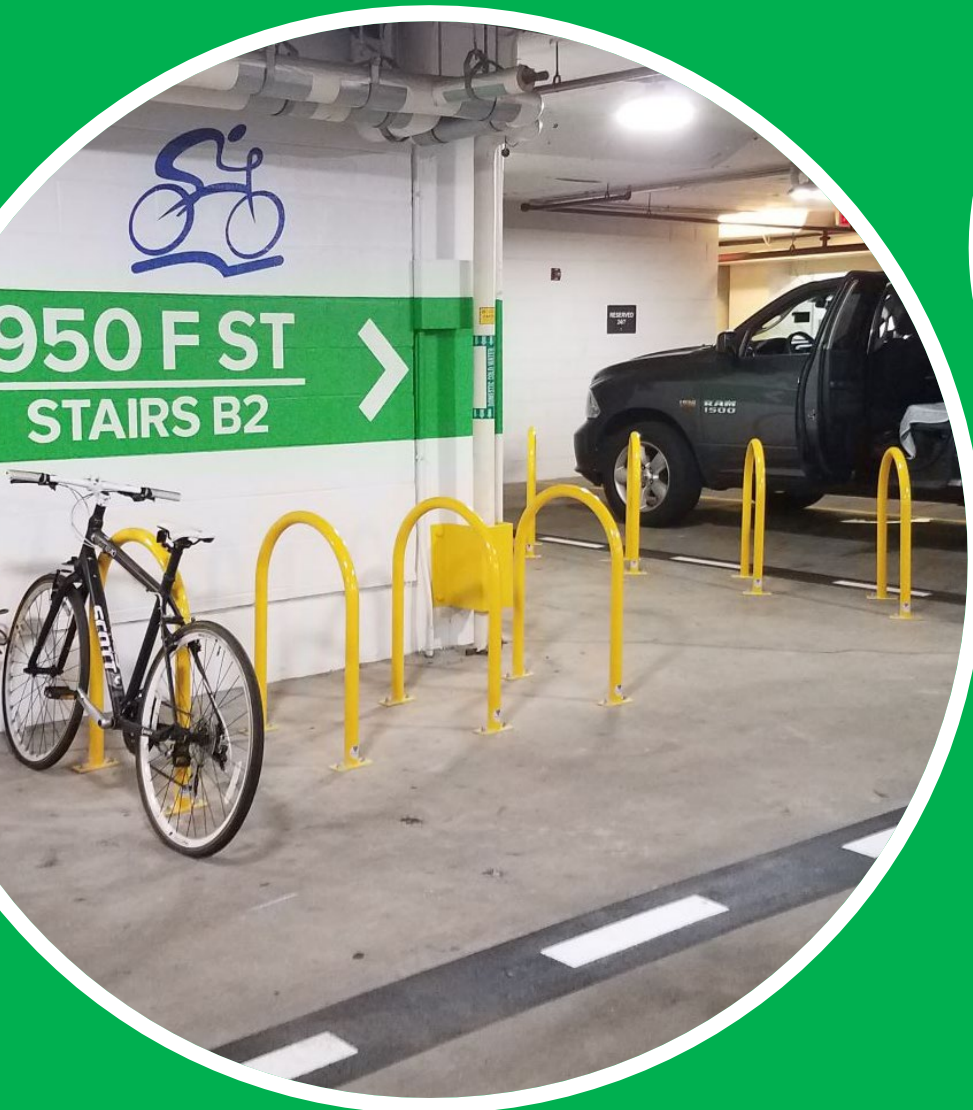

Vertical Parking



Two-Tier Parking



Lockers and Shelters



Installation Surfaces

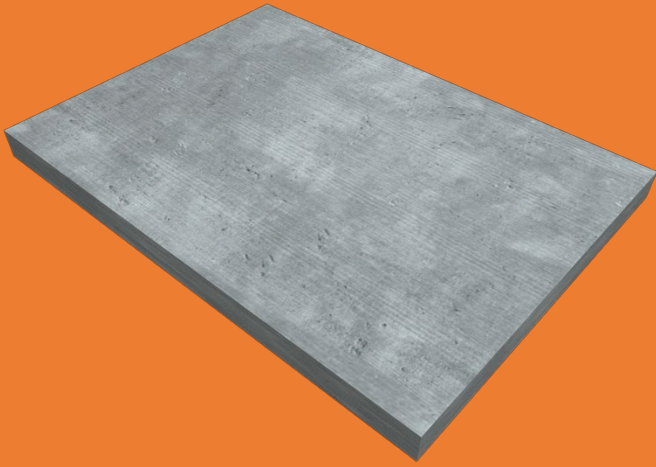

Concrete

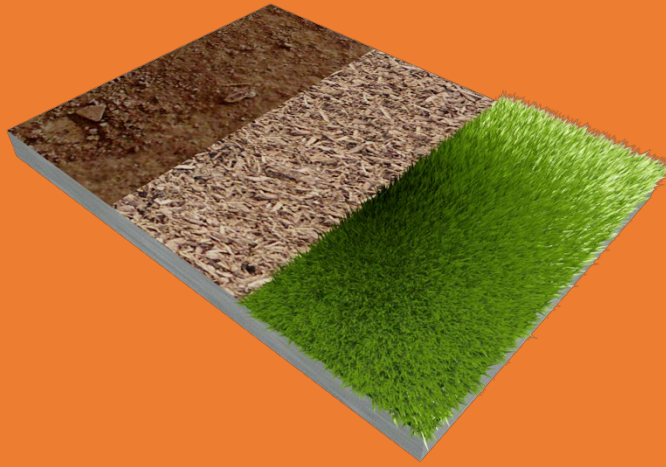

Dirt/Mulch/Grass

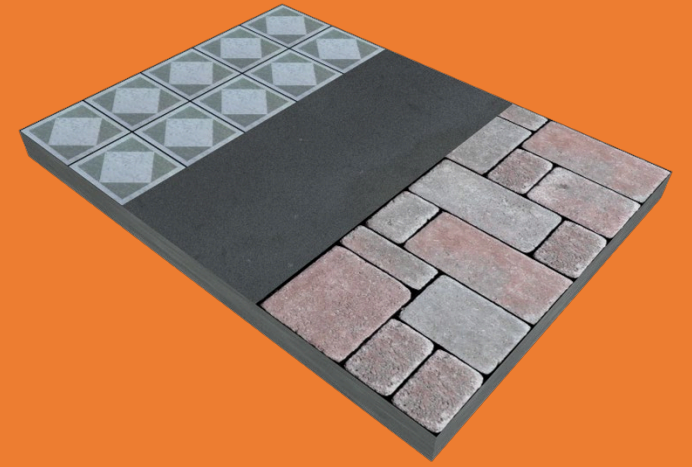

Tile/Asphalt/Pavers

Wall Material

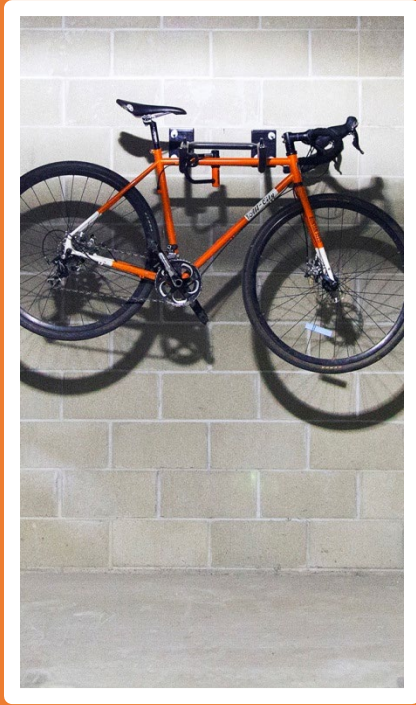

Concrete Block
(SLEEVE anchors)

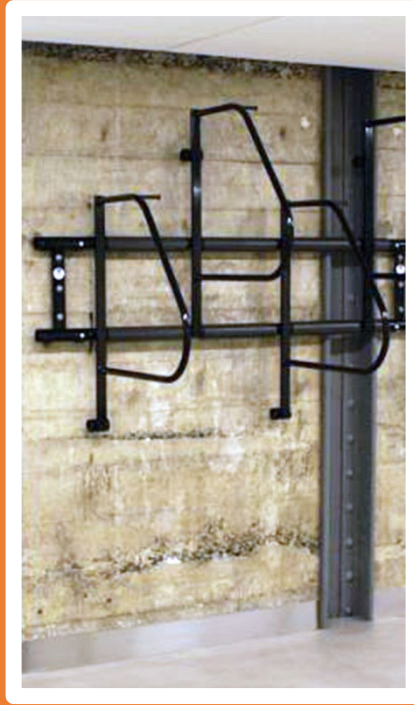

Poured Concrete
(WEDGE anchors)

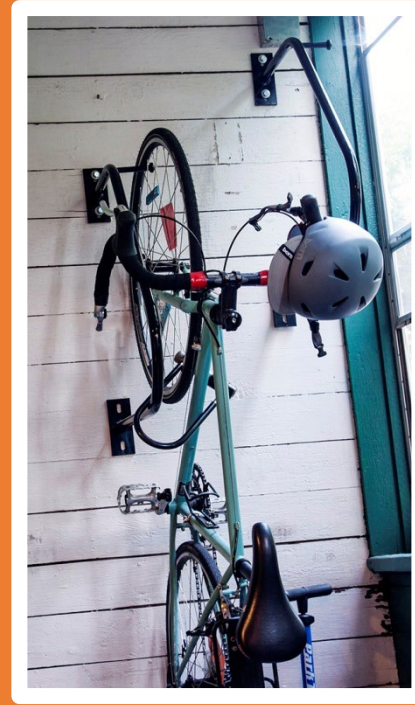

Wood Stud
(LAG SHIELD anchors)

Auxiliary Items



Pump and Tools

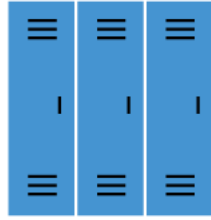

Storage



Signage

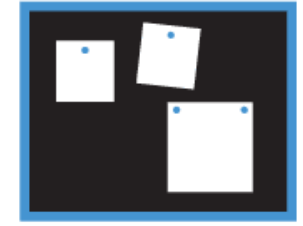

Maps and Messages



Pump and Tools

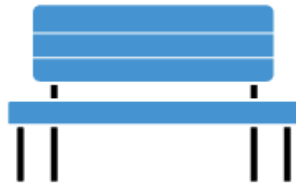

Seating

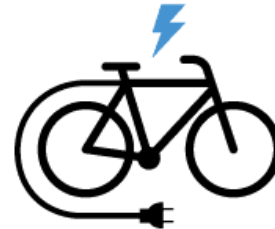

E-Bike Charging



Wash Stations





1. How many bikes parked?
2. Where's the location of the facility versus the desired destination of people using it?
3. What's the budget?
4. Security measures
5. Space description
 - Obstructions
 - Doorways
 - Room measurements
 - Ceiling height

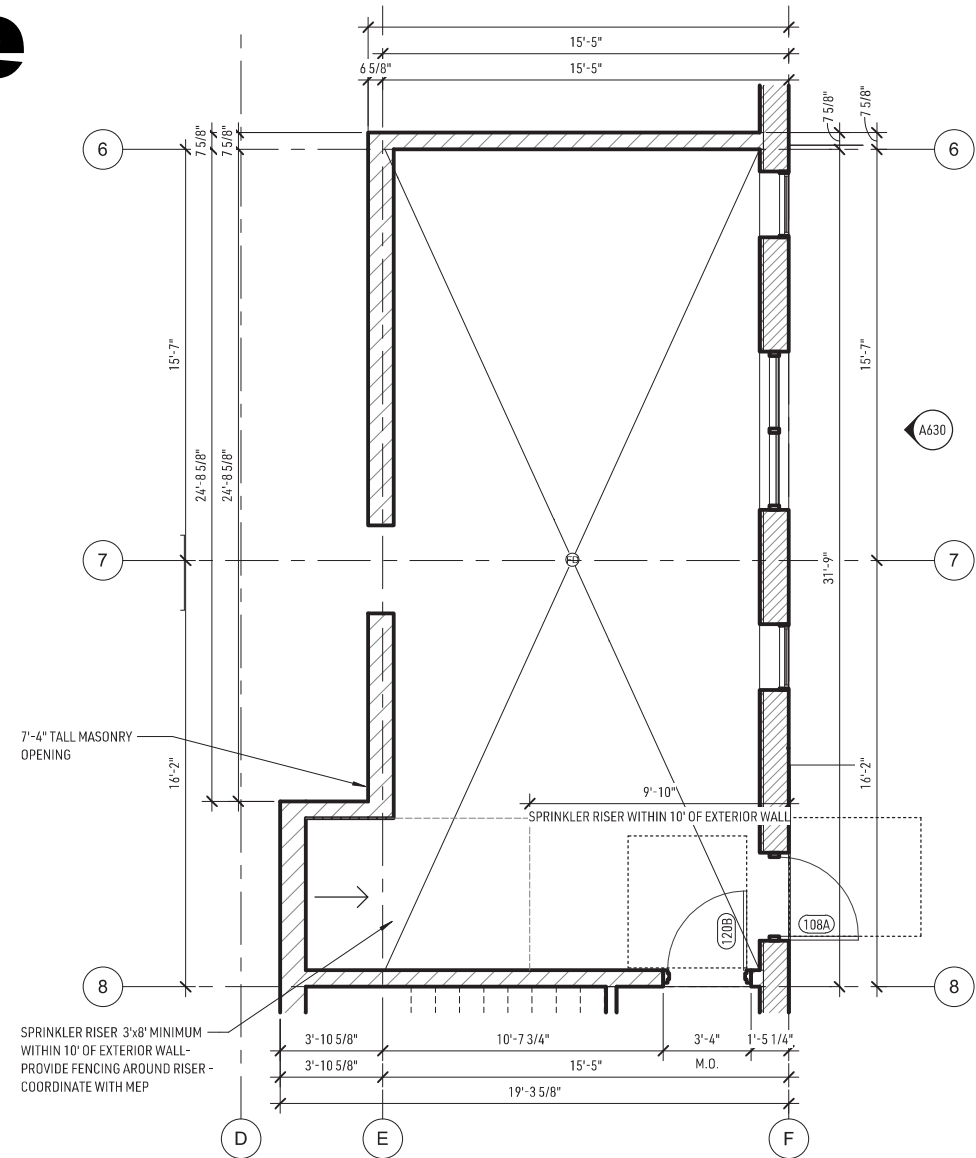

**Include
bikes in your
layouts!**

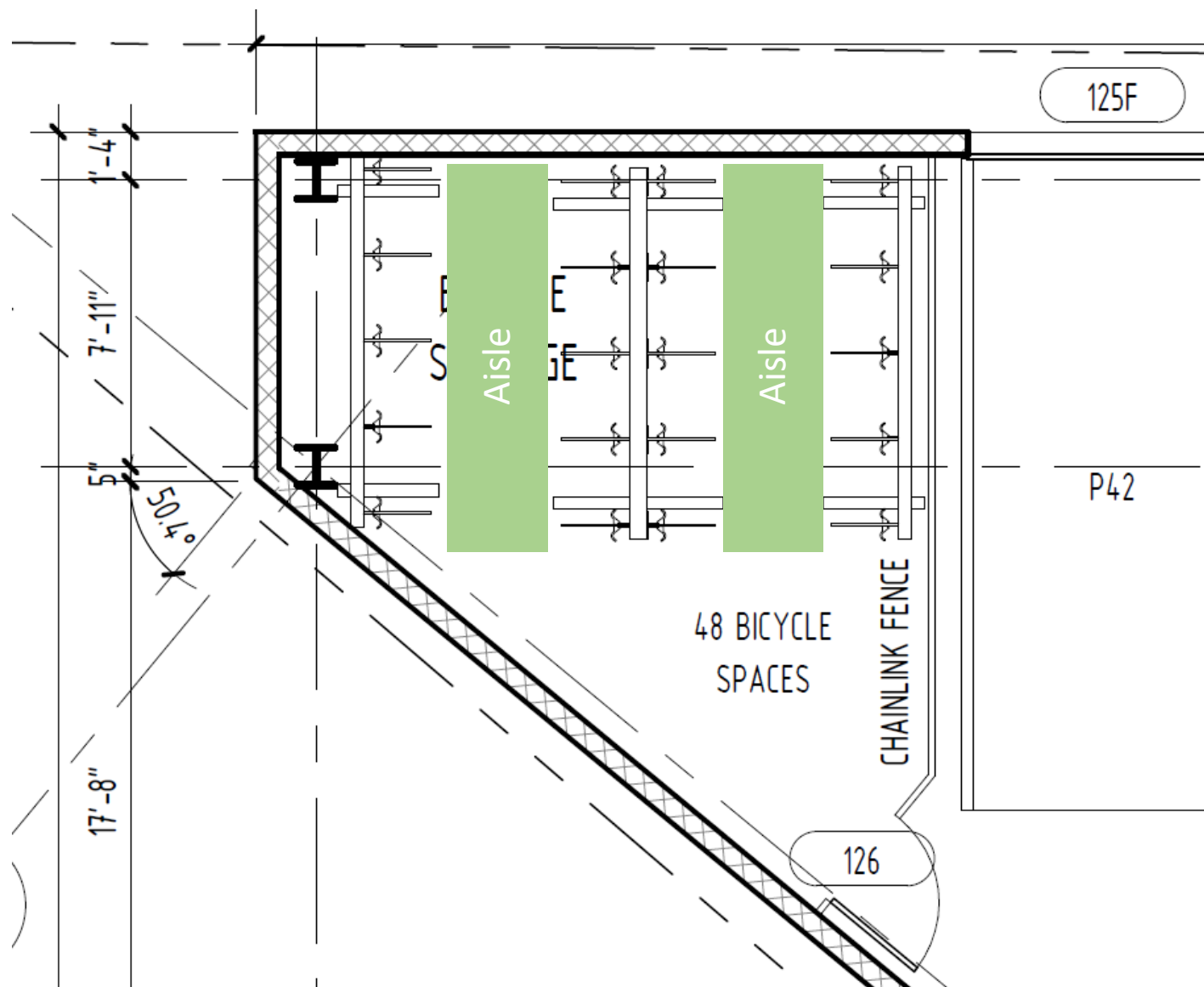

**Include
bikes in your
layouts!**

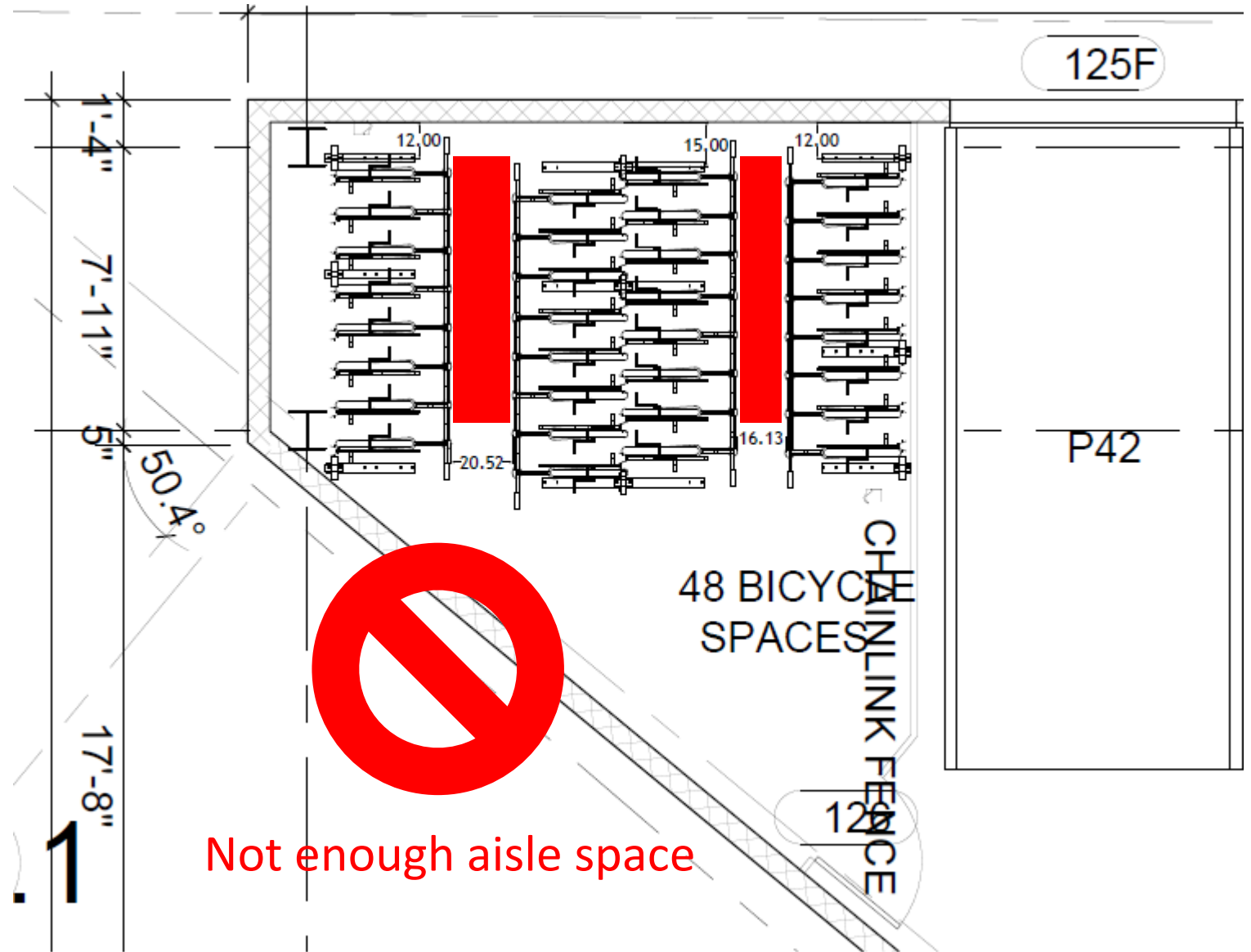

Optimizing Capacity and Space Use

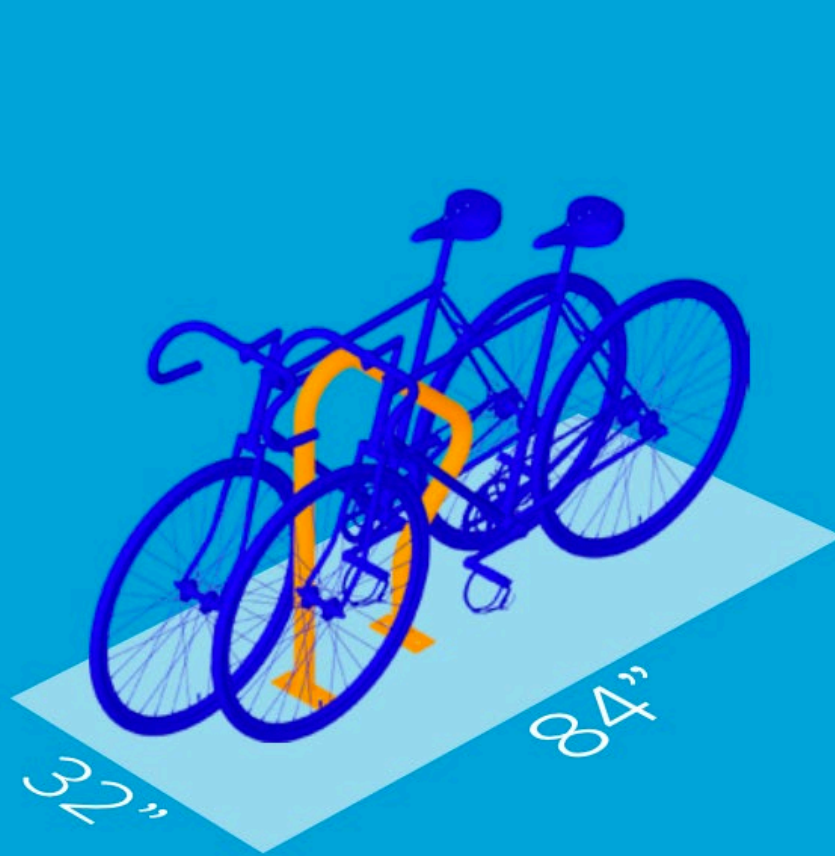

Horizontal



Vertical

Room to Move

- Single aisle is the simplest layout
- Employ a mix of bike parking types to accommodate as many bikes and people as possible
- Work from a design that can be scaled over time if needed (tight budget)
- Amenities (variable): maintenance station; bench; storage locker; signs; shower bathroom; ART
- Floor AND MEP layouts need to be clear

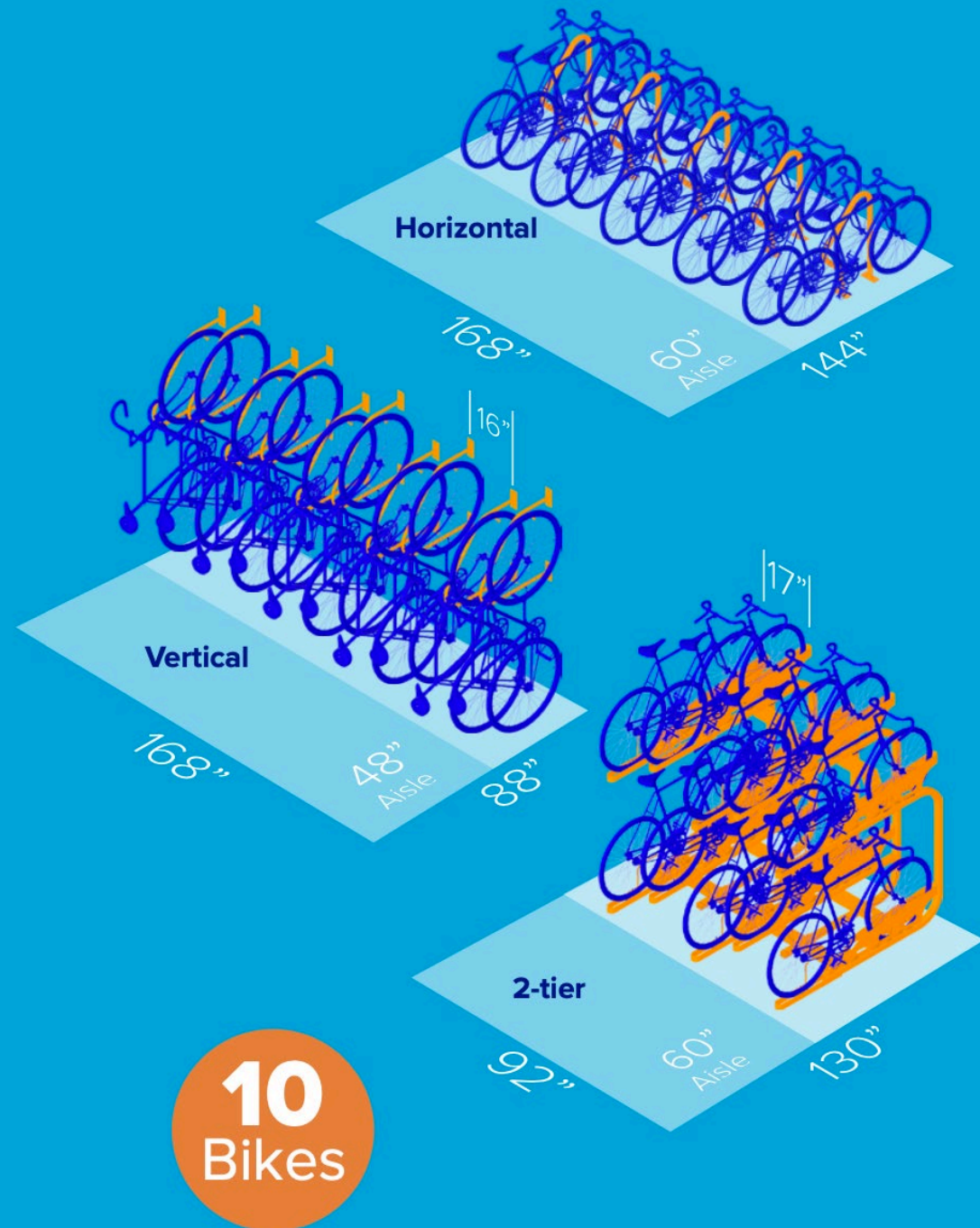

Consider All Users

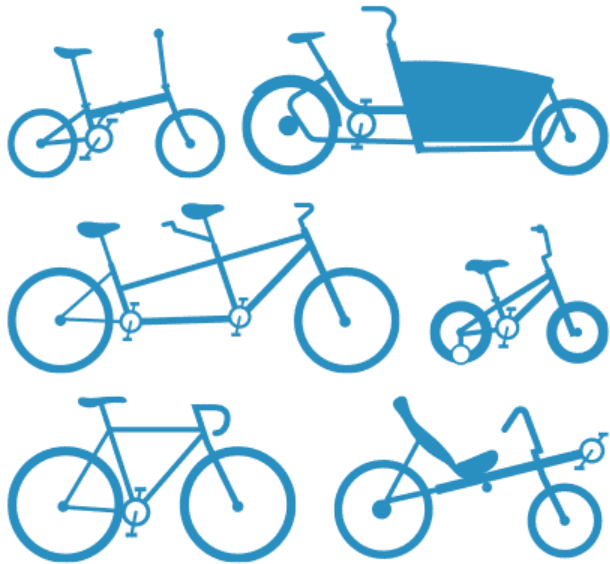

Different Spokes

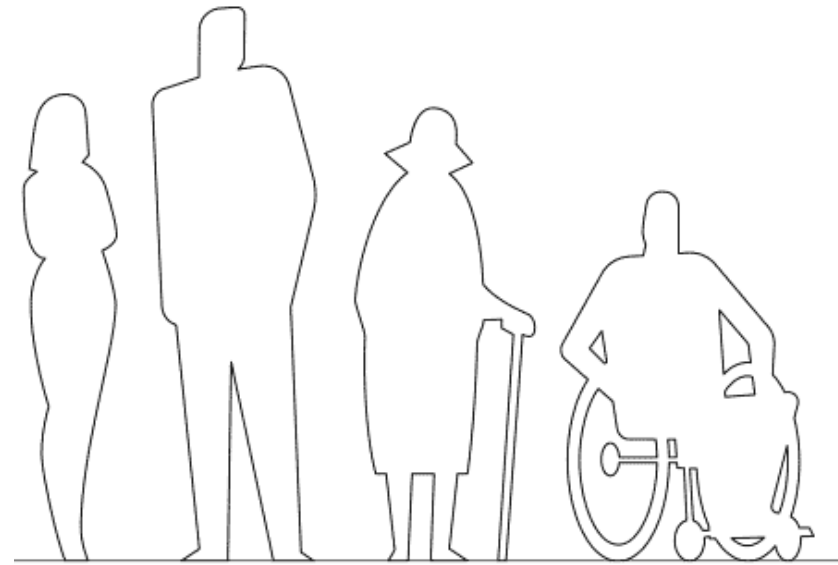

Different Folks

ADA Compliance

Post Mounted Objects

12" maximum overhang when located between 27" and 80" (vulnerability zone) above the finish floor

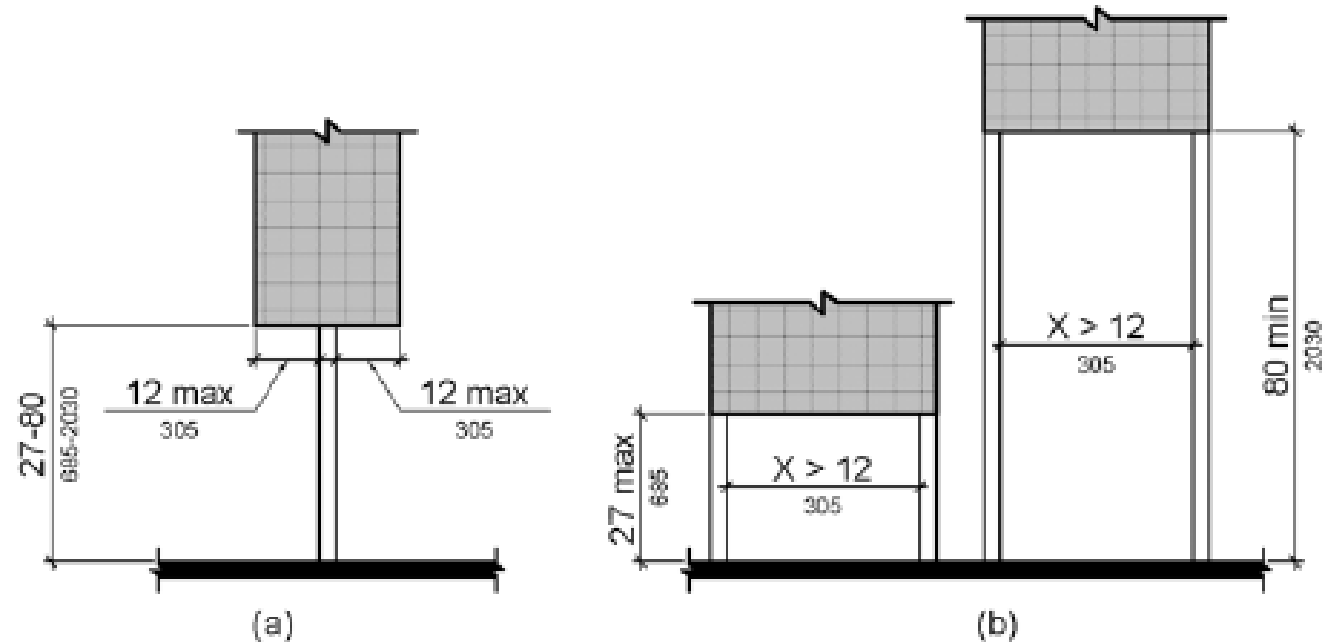

Figure 307.3 Post-Mounted Protruding Objects

ADA Compliance

Limits of Protruding Objects 307.2

“Shoreline” & Circulation paths

Objects mounted on walls, partitions, columns, and other elements can pose hazards

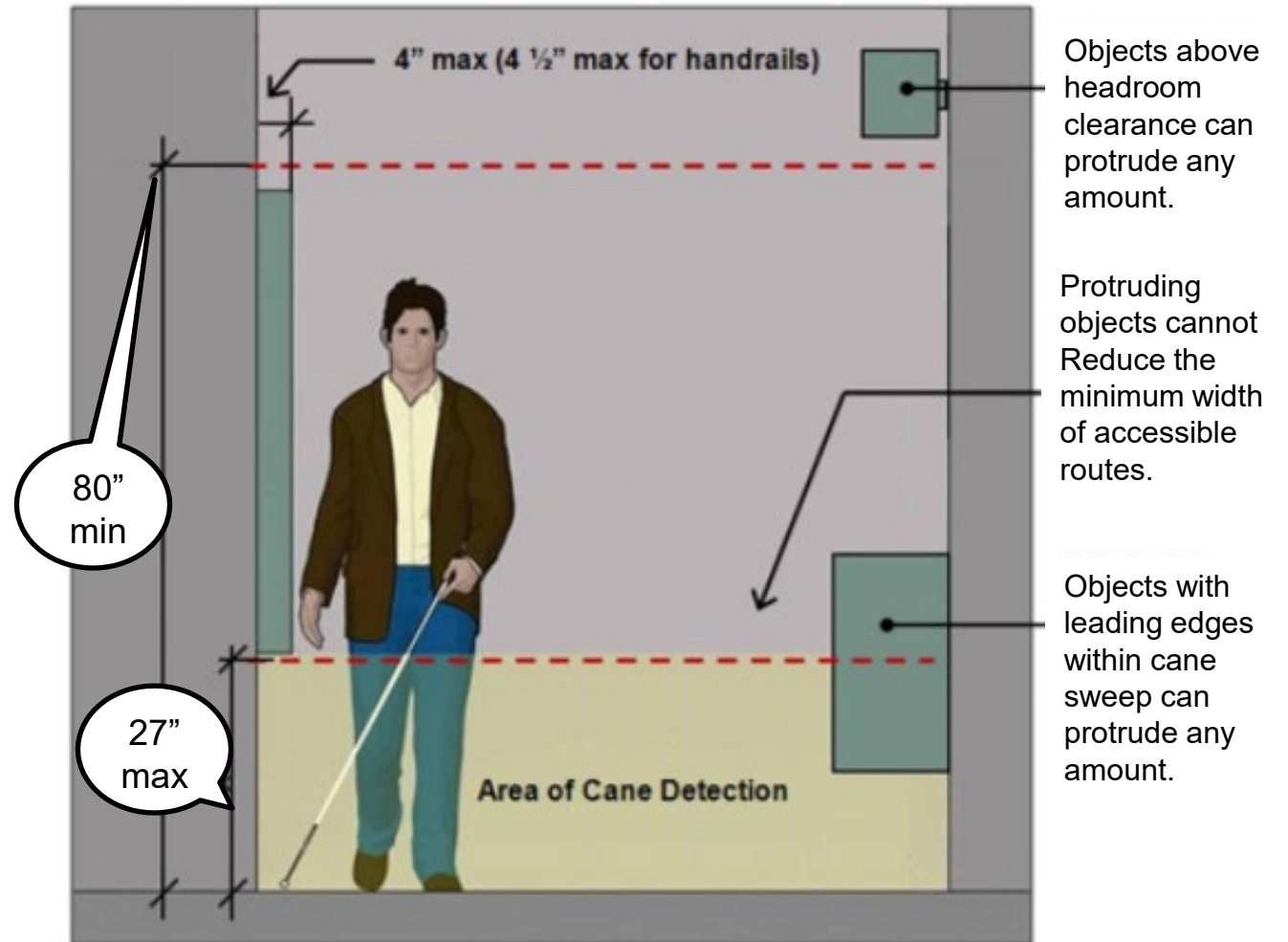

ADA Sample Layout

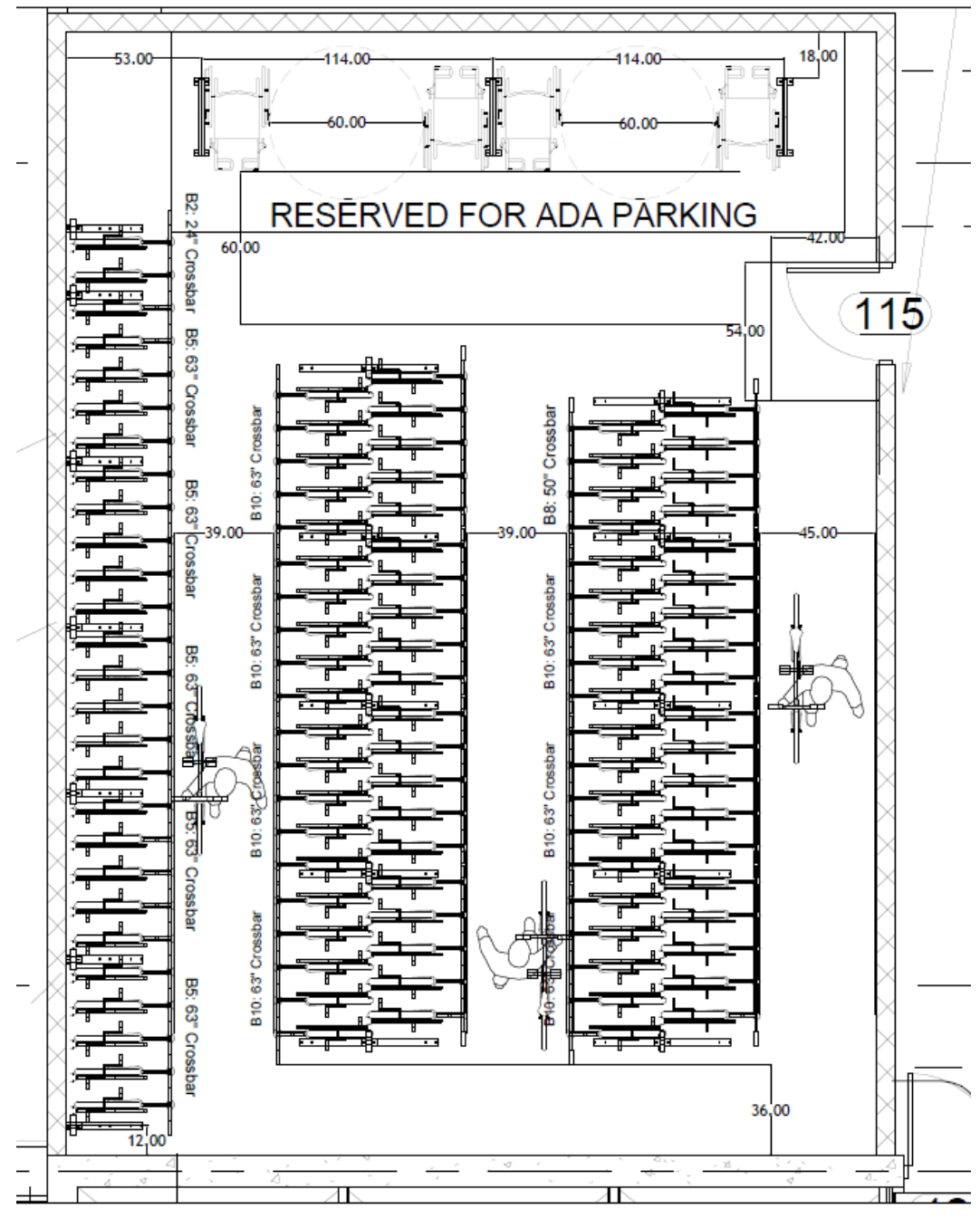

Sample Layout

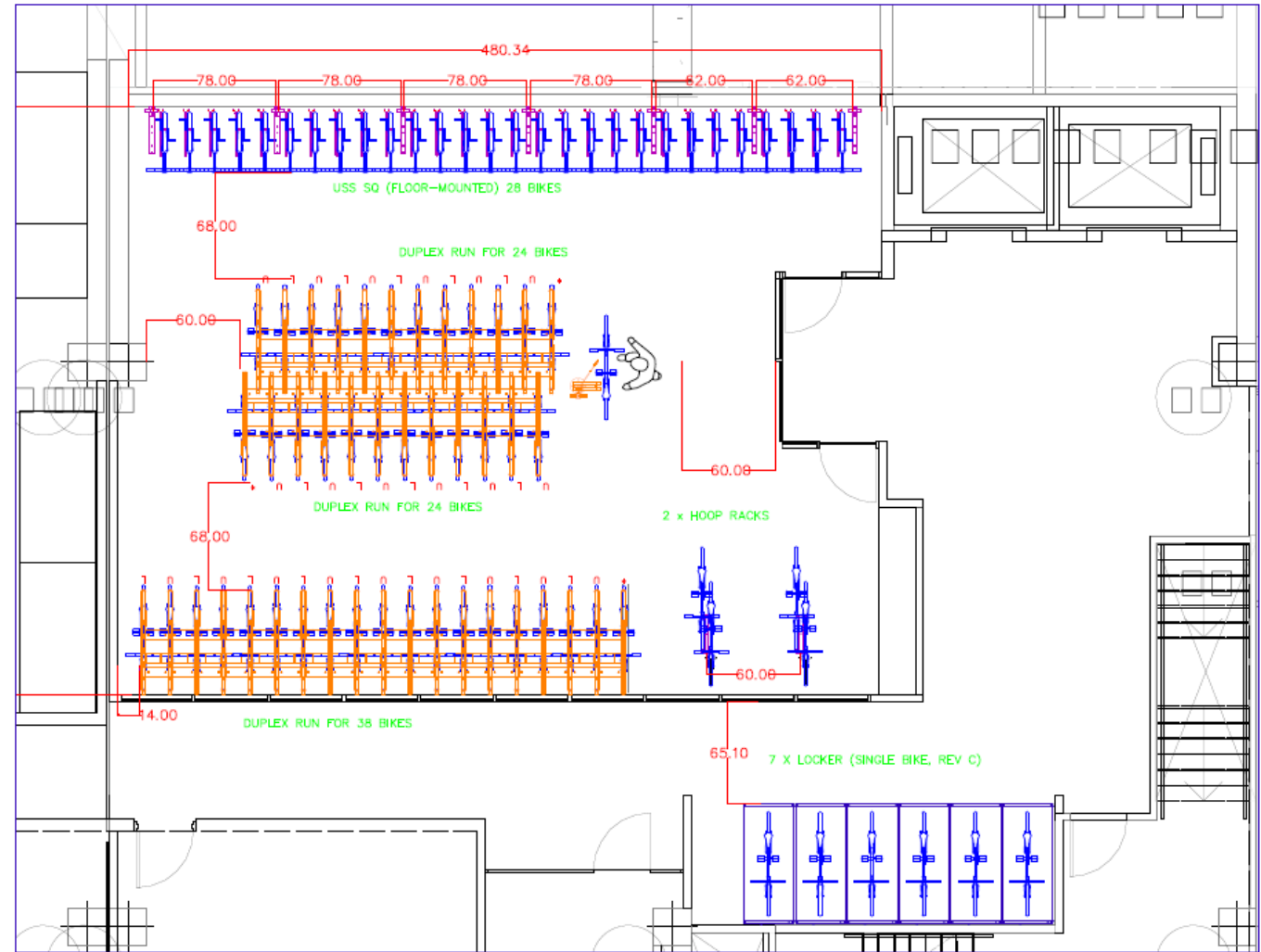

Quality Standards



**Quality
Standards**



Parksmart

Quality Standards



Local Ordinances

Common Pitfalls

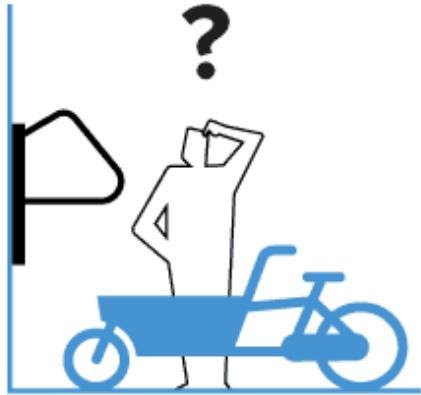

Not enough
parking options

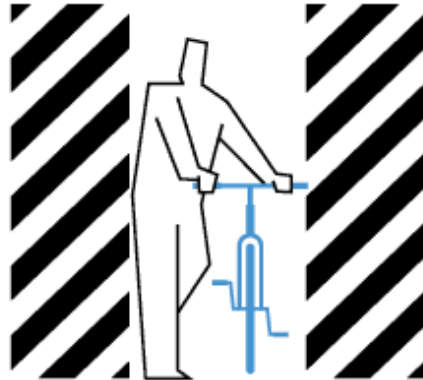

Not enough
aisle space



Insufficient
lighting

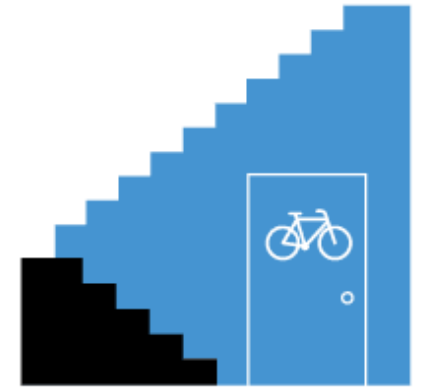

Poor
access

Due Diligence

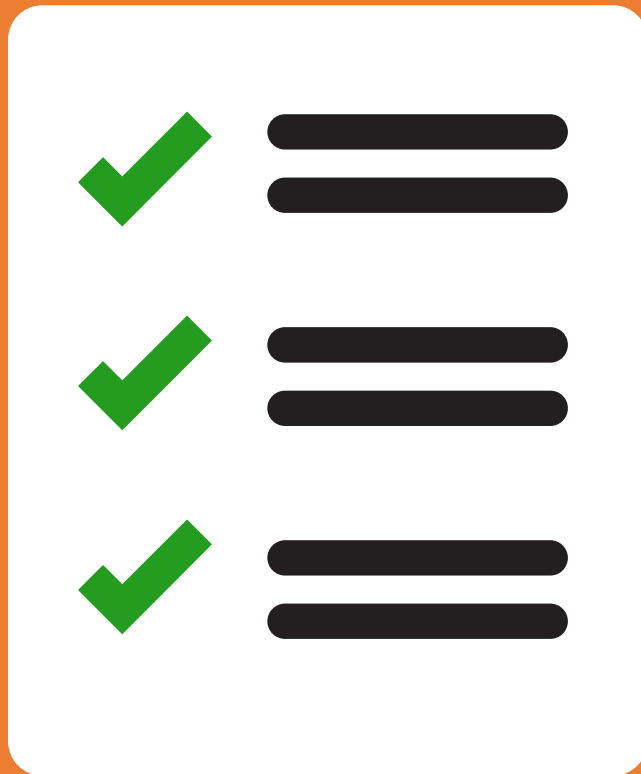

- How well are vendors able to provide guidance about their products and the choices associated with them?
- Warranty terms?
- Control of manufacturing?
- Value added services like CAD layouts and access to common file types of products to easily upload in the design phase of your projects?
- Do the people designing and selling the bike racks use bikes for transportation?
- Videos that demonstrate how some of the more complex systems function?

Example Project

Ponce City Market *Atlanta, GA*

- Mixed use development
- Horizontal and vertical
- Horizontal, tiered
- Public, bike valet, and reserved

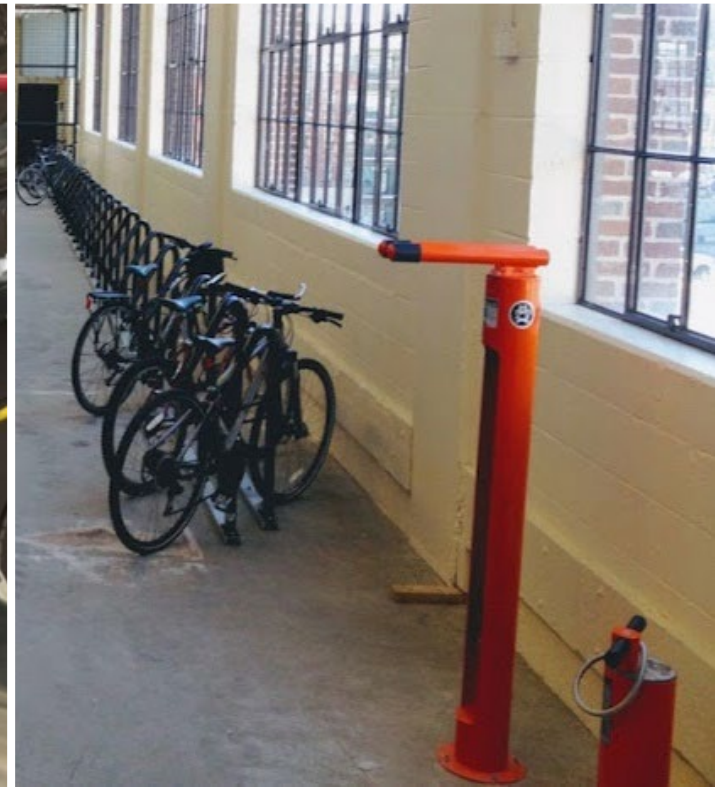

Example Project

Green Building Alliance
Pittsburgh, PA

- Dream Bike Room
- Whimsical & Fun



Example Project

Trek Development
Pittsburgh, PA



Bold Signage

Public Parking

Repurposed shipping containers

Looking to the Future



Resources

- Bicycles at Rest – www.bicycleparkingonline.org
- Victoria Transportation Policy Institute - <http://www.vtpi.org/tdm/tdm85.htm>
- Essentials of Bike Parking – www.apbp.org
- Dero Bike Parking Guide - <https://www.dero.com/bike-parking-guide/>
- Dero Bike Room Design Guide – <https://www.dero.com/bike-room-design-guide/>
- San Francisco Planning Department – <http://sf-planning.org/bicycle-parking-requirements>
- Pittsburgh Department of Planning - <http://pittsburghpa.gov/dcp/bicycleparking>
- Look for Master Plans in the region you're working to learn more about the communities vision for the role of bikes in mobility. Bike parking goes hand in hand with mobility plans.

Questions

